

Ringcone Popet

RK - 1 Model Instruction Manual

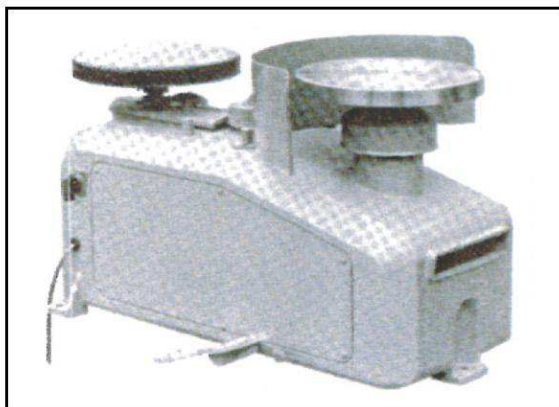

SHIMPO INDUSTRIAL CO., LTD

- Thank you for purchasing this SHIMPO product

We are very glad you have chosen to buy a Ringcone Popet RK-1 Potter's Wheel. This wheel is a new product of Japan, a potter's country through long tradition. A highly perfect non-stop variable speed wheel born of our unique technical skill and experience.

This wheel is in wide use not only by professional potter's and amateurs in Japan, but by enthusiastic potters everywhere. Read the instruction manual carefully to get the peak performance and long-use of the Ringcone Popet wheel.

● INDEX

Parts List and Specifications	2
How To Operate	2
Replacing the Drive Ring (No. 1)	3
Drive Ring Removal and Installation (No. 2)	4
Drive Belt Removal and Installation	5
Torque Adjustment (Increasing)	6
Torque Adjustment (Decreasing)	7
Troubleshooting	8

● Parts List and Specifications

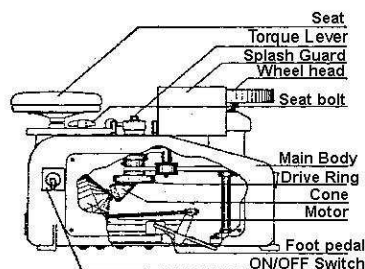

Specifications:

- Wheel Head Speed
50 Hz 0~200 rpm, 60Hz 0~240 rpm
- Wheel Head Direction:
Clockwise, Counter-clockwise
- Metal die-cast Wheel Head
- Electrical specifications
200W (1/4 HP) 100V (single phase)-200V (3 phase)
- Dimensions:
Width: 550 mm, Length: 520 mm, Height: 500 mm
Wheel Head Diameter: 300 mm

● How To Operate

1. **Installation:** Please place wheel on a level surface to avoid rocking.
2. **Seat Position:** Adjust seat to comfortable height by turning the seat cushion.
Adjust seat forward and backward by loosening the Seat Bolt
3. **Using the wheel:** Plug in firmly.
Sit with the wheel head in front of you.
Turn ON/OFF switch to either Forward or Reverse direction.
4. **Wheel Head Speed:** Press foot pedal down to achieve variable wheel head speed.
5. **Wheel Head Direction:** To change direction of spin, turn knob to the off first, making sure the motor is completely stopped.
Then turn knob to either the Forward or Reverse direction. (if you DO NOT wait for the motor to come to a complete stop first, the wheel head will not change direction)
6. **To Increase Torque:** If an increase of torque is necessary, adjust by using the Torque Lever.
If more torque is required please refer to page 6.
To extend the life of the wheel, a light amount of torque is best for normal throwing use.
7. **When finished using the wheel:** Make sure foot pedal is returned an off position (when wheel head is completely stopped).
Turn ON/OFF switch to OFF

*Failure to release foot pedal will cause a bump in the rubber drive ring and will cause a thumping the next time the wheel is used.

How To Replace the Drive Ring

1. For safety, please unplug the wheel.
2. Find a clean work space.
3. Keep parts clean after disassembly.

Attention: If bearing cover (No. 5) is easily removed follow the directions in No. 1. If bearing cover is NOT easily removed, refer to directions according to No. 2.

● Replacing the Drive Ring (No.1)

1. Take off Side Cover (1) on the foot pedal side of the wheel by removing the Mounting Screws (2).
2. After removing Side Cover (1) push down the foot pedal (3) to the Zero Position. (Zero Position is when wheel is at a full stop)
3. To remove the Bearing Cover (5) you must unscrew the bolts (4).
4. Take out the Bearing Cover (5) then take out the Drive Ring (6).

* To re-assemble follow these steps in reverse

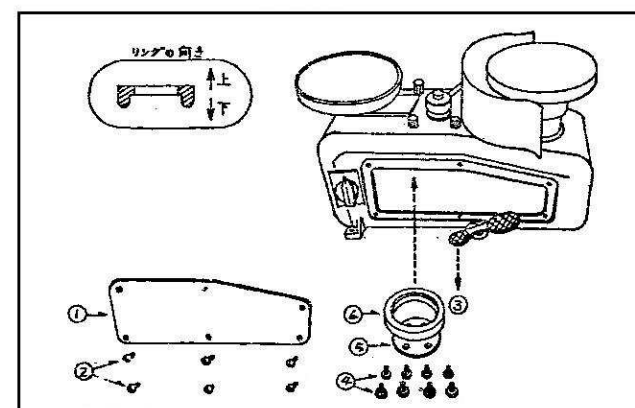

● Drive Ring Removal and Installation (No. 2)

- Step 1
1. Remove plate (#1 in diagram) by unscrew 6 screws (# 2 in diagram).
 2. Next make sure the foot pedal is in the stop position (zero position), (# 3 in diagram).
 3. Remove speed lever handle (# 5) by removing the nut in part # 4.
 4. Remove the speed lever handle, (# 5).
 5. Remove bearing mount (#7) by removing the bolts (#6).
 6. Complete remove bearing mount (# 7) from the unit.
 7. To remove bottom bearing cover (#9), remove the 8 screws (#8).
 8. Once bottom bearing cover (#9) is removed, remove drive ring (#10).
- ✱ To re-assemble, follow instructions in reverse.

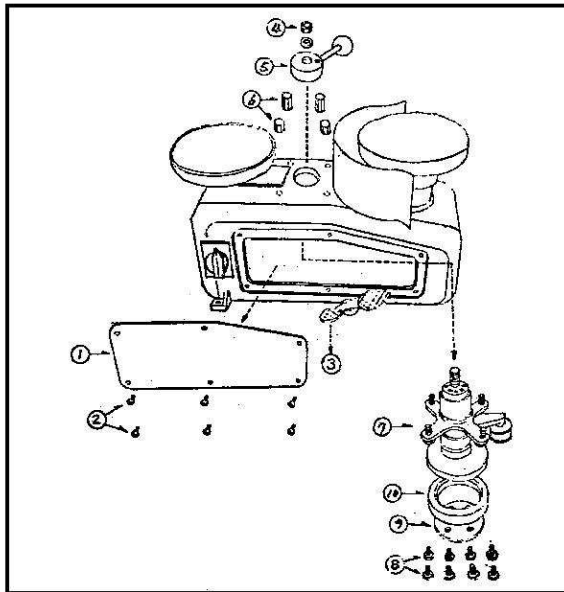

● Drive Belt Removal and Installation

- Step 1
1. Remove plate (#1 in diagram) by unscrew 6 screws (# 2 in diagram).
 2. Next make sure the foot pedal is in the stop position (zero position), (# 3 in diagram).
 3. Remove Wheel Head (# 4) by unscrewing bolt (# 5).
 4. Take off Wheel Head.
 5. Remove metal dust cover (# 6).
 6. Remove bearing holder (# 8) by unscrewing bolts (# 7).
 7. Remove bottom bearing holder (# 10) by unscrewing bolts (# 9).
 8. Remove the belt by lifting the shaft (# 11).
- ✱ To re-assemble, follow instructions in reverse.

Caution: Do not add oil or grease to or on the belt.

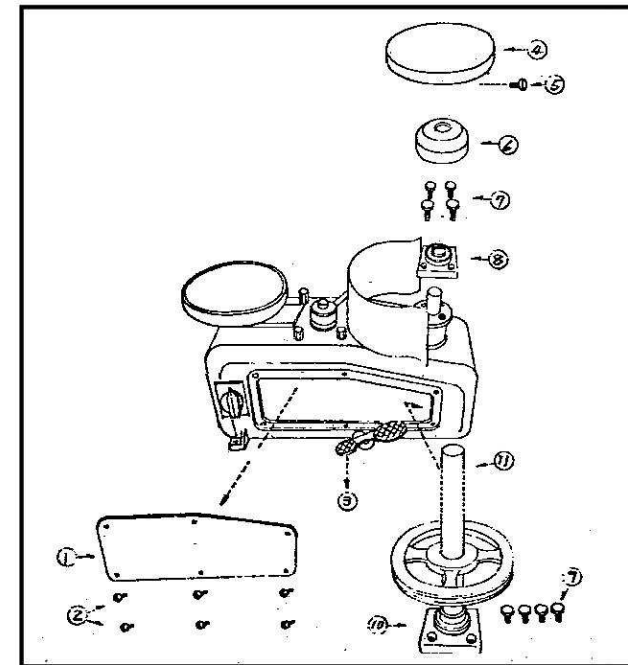

Torque Adjustment

● How to adjust your Torque - Increasing Torque

When centering or throwing that requires a high amount of torque and torque is low or slipping, regardless of using the torque lever, follow the instruction to increase your torque.

Step 1

1. Move torque lever (# 1) to the maximum torque position. Then unscrew nut (# 2).
[refer to diagram 1]
 2. Remove torque lever and reposition it in the lowest torque position by lining up the notch (# 3) on the lever to the lowest notch on the shaft base (# 4).
[refer to diagram 2]
Next turn torque lever towards the highest torque position, creating tension in the torque lever).
[refer to diagram 3]
 3. Then remove the torque lever and replace it in the middle position of the shaft base.
[refer to diagram 4]
 4. Replace nut (# 2) back onto the lever.
[refer to diagram 4]
- * If torque is still low and slipping please follow steps 1 through 4 again.

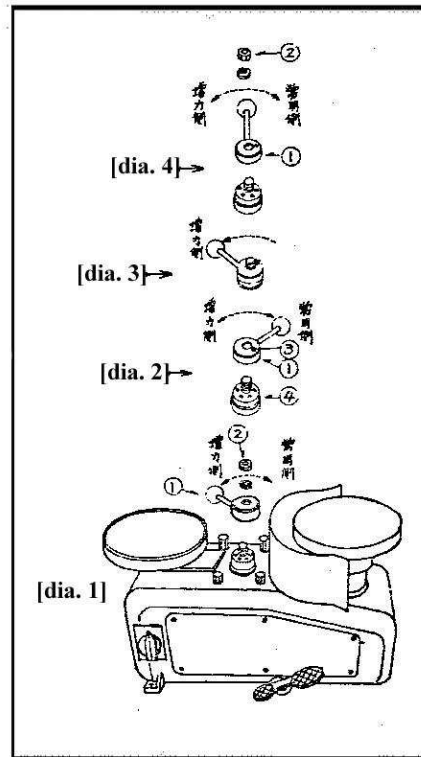

Torque Adjustment

● How to adjust your Torque - Decreasing Torque

When centering or throwing that requires less torque and torque is too high, regardless of using the torque lever, follow the instructions to decrease your torque.

Step 1

1. Move torque lever (# 1) to the lowest torque position. Then unscrew nut (# 2).
[refer to diagram 1]
 2. Remove torque lever and reposition it in the highest torque position by lining up the notch (# 3) on the lever to the highest notch on the shaft base (# 4).
[refer to diagram 2]
Next turn torque lever towards the lowest torque position, creating tension in the torque lever).
[refer to diagram 3]
 3. Then remove the torque lever and replace it in the middle position of the shaft base.
[refer to diagram 4]
 4. Replace nut (# 2) back onto the lever.
[refer to diagram 4]
- * If torque is still high and slipping please follow steps 1 through 4 again.

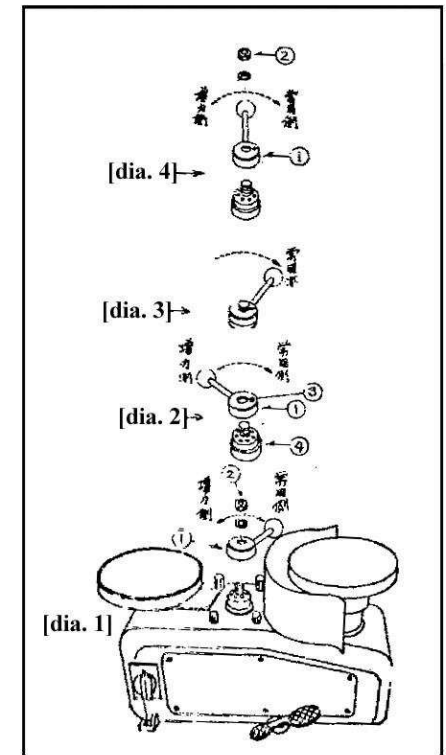

Troubleshooting

Wheel Doesn't Turn

Electrical problem

- Switch doesn't turn on → Make sure wheel is unplugged then check to see all wires are tightly connected.
- Electrical Short → Contact a licensed electrician.
- Fuse blow-out → Replace with a new fuse.

Wheel Does Not Increase in Speed

- Wheel Head Slips → Check to see if cone is making a pressure contact with ring, (pressure is weak).
Move Torque lever towards maximum position.
- Foot Pedal Does Not Move → Check to see if cone is making a pressure contact with ring, (pressure is too strong).
Move Torque lever towards minimum position.
- Cone is Slipping → Make sure cone is free of oil or grease.

Wheel is Making Noise

- Defective Ring → Replace Ring.

● SHIMPO AFTER CARE SERVICE

Our company strives to achieve the best quality product with zero defects.
We make a strong product for customer confidence while using this product.
We warranty all our products from defective materials and workmanship except natural disasters. Please feel free to contact us.

◆ SHIMPO INDUSTRIAL CO., LTD.

338 Tonoshiro-cho, Kuze, Miniami-ku, Kyoto, Japan

Phone: Kyoto (075) 921-7151

Cable "SHIMPO KYOTO" Telex: 5429 903 SHIMPO J

大宮出張所/大宮市橋引町1丁目485番地 〒330 TEL 大宮(0486)64-5870

名古屋営業所/名古屋市西区枇杷島通り5丁目24番地 〒451 TEL 名古屋(052)521-4281(代)

大阪営業所/大阪市北区兔我野町67番地の1
梅田グリーンビル 〒530 TEL 大阪(06)312-1191(代)

広島営業所/広島市金屋町8番14号 〒730 TEL 広島(0822)61-7385

福岡営業所/福岡市博多駅南2丁目3番32号 野村ビル 〒812 TEL 福岡(092) 41-4750

海外駐在員事務所/シカゴ, 台北